

Operation

Power Switch

Types of Power Switches

- This machine has the Main Power Switch, the Control Panel Power Switch and the Environment Heater Switch.
- Turning ON the Main Power Switch supplies the power in the usual case (except when the machine is in sleep mode).
- The Environment Switch supplies or blocks the power to the Drum Heater, the Cassette Heater and the Reader Heater.

Points to Note on Turning ON/OFF the Power Switch

- Do not turn OFF the Main Power Switch while the progress bar (to be displayed when the power is turned ON) is displayed, which indicates access to the HDD.
- Be sure to turn OFF the Main Power Switch to cut the power (there is no need to perform the shutdown sequence which has been performed with the conventional machines).
- After turning OFF the power (after turning OFF the Main Power Switch), do not turn ON the Main Power Switch unless the screen disappears.
- Do not turn OFF the power during downloading.

Control Panel

Control Panel

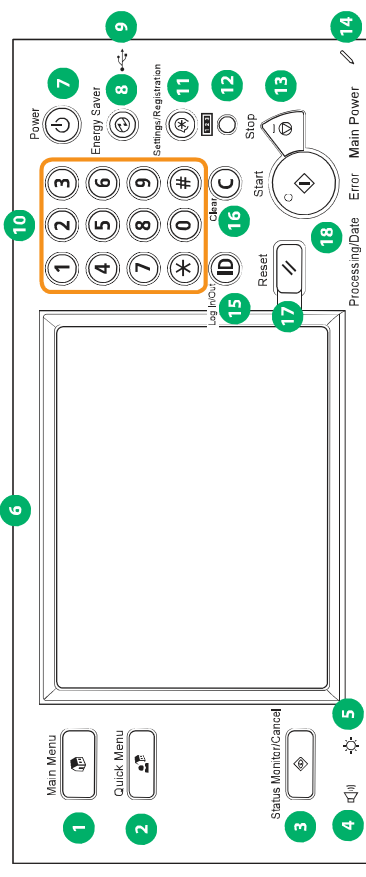

F-1-17

- | | | | |
|-----|--|------|---------------------------|
| [1] | Main Menu Key | [10] | Numeric Key |
| [2] | Custom Menu Key | [11] | Settings/registration Key |
| [3] | Check/Stop Status Key | [12] | Check Counter Key |
| [4] | Volume Adjustment Key | [13] | Stop Key |
| [5] | Brightness Adjustment Key | [14] | Operation Pen |
| [6] | Touch Panel Display | [15] | ID Key |
| [7] | Control Panel Power Switch (Sub-power) | [16] | Clear Key |
| [8] | Energy Saver Key | [17] | Reset Key |
| [9] | USB Slot | [18] | Start Key |